

The original and still the best...

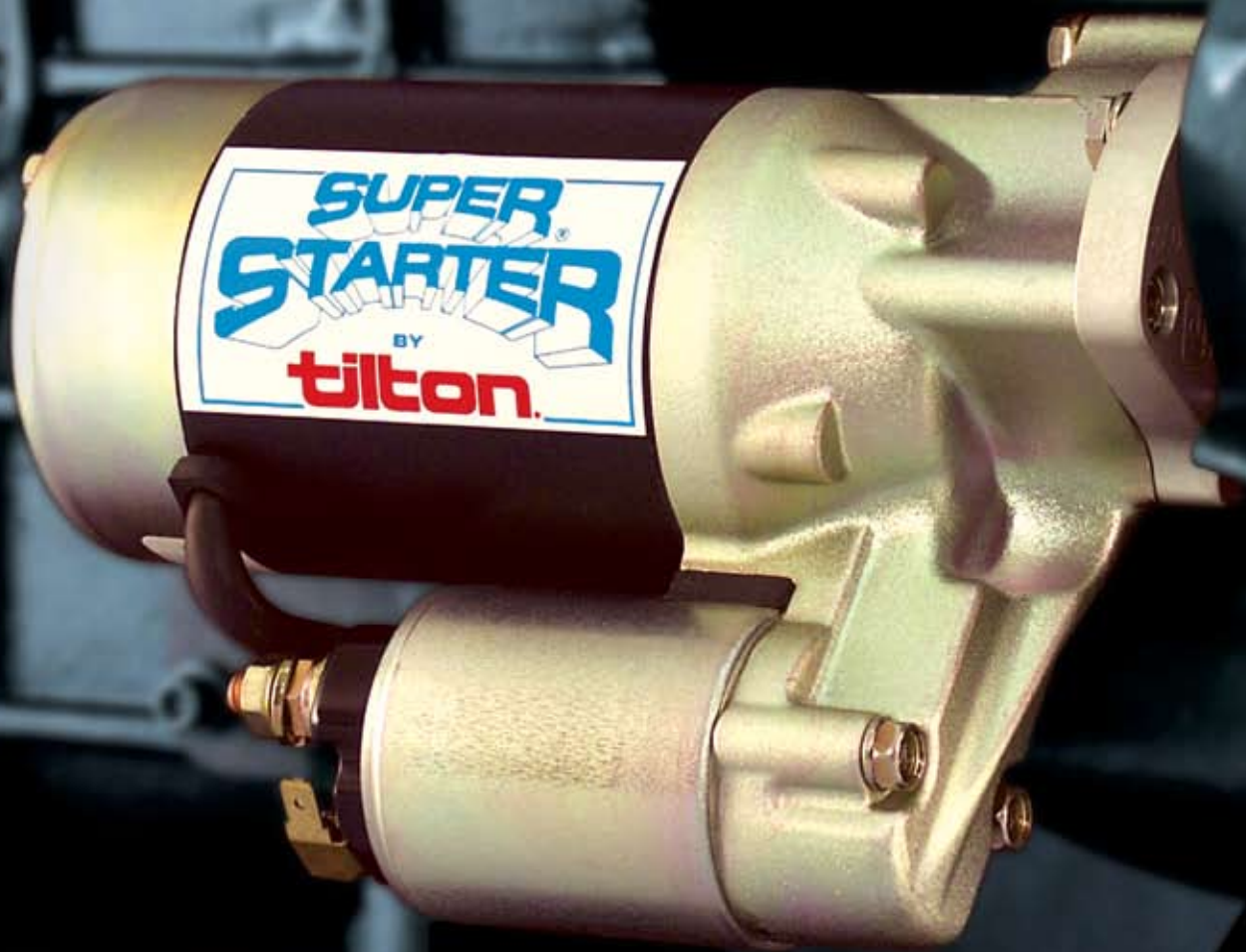

Celebrating 25 years of starting the worlds finest engines.

Super Starter® Celebrates 25 Years of Dependable Starting

For 25 years, the Tilton Super Starter® has provided dependable starting for the world's finest engines. Introduced in 1981, the Super Starter® is the original high performance gear reduction mini starter. It has become the benchmark for starters used in high performance and racing applications. While other "high performance" starter companies have come and gone, the Super Starter® has earned its reputation for providing dependable starting under the most extreme conditions.



Today, the Super Starter® is used in many applications and almost every form of racing worldwide. They can be found virtually anywhere, from your neighbor's work truck, to a prototype race car competing in the 24 Hours of Le Mans. Often imitated, but never duplicated, the Super Starter® is the ultimate in starter technology. Super Starters® are available worldwide from premiere racing and high-performance distributors.

What makes a Super Starter®?

Quality

How many companies introduce a product, gain market share, start cutting quality and then reduce prices to stay competitive? Nothing could be farther from the truth with Tilton products and how we do business. The Super Starter® is no exception and follows the "Tilton Difference Philosophy".

Over the last 25 years, the Super Starter® has undergone continuous improvements through the experience and technical relationships we have with our customers in motorsports. The knowledge we gain working with motor-sport customers and their grueling requirements, helps us to build you the best starter possible. Today, there are more Super Starter® models available than ever before. They benefit from proven engineered designs, top quality components, the latest manufacturing processes and strict quality control standards. Every Super Starter® is individually dyno-tested at Tilton Engineering prior to shipment.

Selection

Super Starters® are available as an upgrade to many Original Equipment (OE) starters and for many specialty/custom applications. They are available in four different motor platforms (Standard Duty, Severe Duty, XLT and PMT). In addition, most Super Starter® platforms are available with standard or reverse rotation, chrome plating and marine sealing options.

Rebuild Services

Tilton produces "new" as opposed to "remanufactured starters". We do offer rebuild services for customer's Super Starters®. Each Super Starter® sent in for service is thoroughly inspected by trained personnel, rebuilt to "like new" condition and dyno-tested prior to being returned to the customer. In addition to Tilton's on-site service facility, regional Tilton Authorized rebuild facilities are available to service customers quickly with spare parts readily available.

Engineering Services

Tilton offers engineering services to develop Super Starters® for specialty/custom applications. The Super Starter® have been chosen for specialized projects by respected car builders such as BMW Motorsports, Dodge Motorsports, Lola, Porsche Motorsports, Ricardo, Riley Technologies, Saleen, Swift Engineering and many more.

Table of Contents

Standard Duty Starter Information	2
Severe Duty Starter Information	3
XLT Starter Information	4
Specialty Starter Information	5
Application Guide	6-16
Super Starter® Information	17

What Super Starter® is right for me?

Standard Duty Super Starter

Standard Duty Super Starters® are designed for use on engines up to 400 C.I.D. and/or 11:1 compression ratio with a standard diameter flywheel/ring gear.

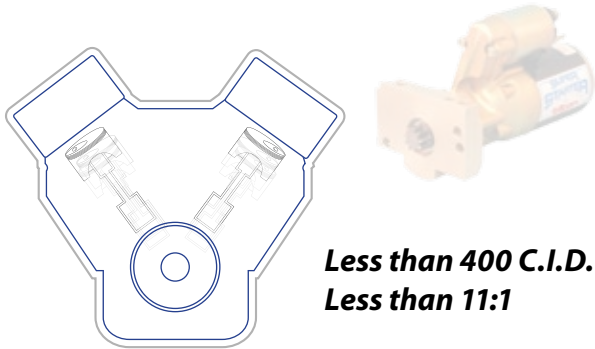

**Less than 400 C.I.D.
Less than 11:1**

See page 2 for more information on Standard Duty Super Starters®, including performance curves and dimensions.

Severe Duty Super Starter

Severe Duty Super Starters® are designed for use on engines larger than 400 C.I.D. and/or over 11:1 compression ratio with standard or small diameter flywheel.

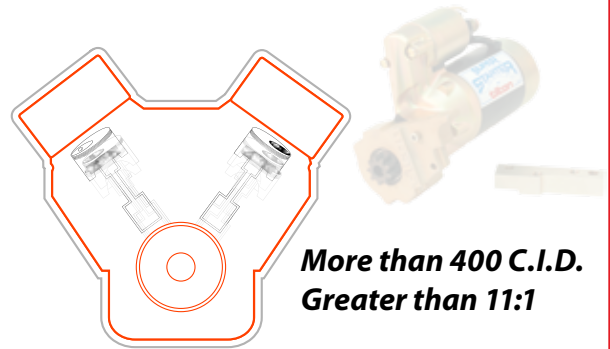

**More than 400 C.I.D.
Greater than 11:1**

See page 2 for more information on Severe Duty Super Starters®, including performance curves and dimensions.

XLT Super Starter

XLT Super Starters® are designed for individuals that desire the most compact and lightest weight starter available. Suitable for use on engines up to 400 C.I.D. and/or 10.5:1 compression ratio with a standard diameter flywheel.

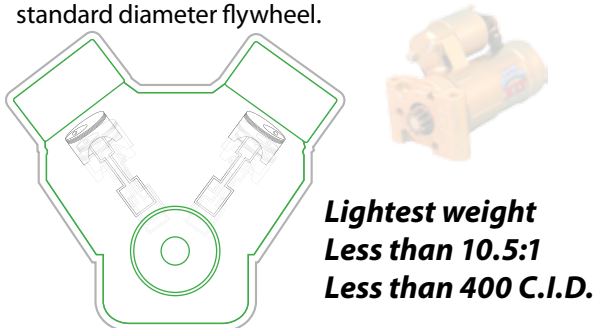

**Lightest weight
Less than 10.5:1
Less than 400 C.I.D.**

See page 2 for more information on XLT Super Starters®, including performance curves and dimensions.

Standard Duty Super Starter

PMT Super Starters® are designed for specialized/custom applications that require a high-torque starter with compact dimensions. Suitable for use on engines up to 400 C.I.D. with a standard or small diameter flywheel.

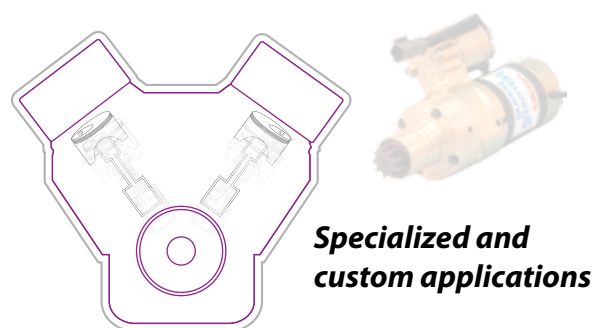

**Specialized and
custom applications**

See page 2 for more information on PMT Super Starters®, including performance curves and dimensions.

Specifications

- 1.9 hp (1.4 Kw) motor
- Weighs approximately 11 lbs. (varies by application)

Recommended Use

Recommended use on most engines up to 400 C.I.D. and/or 11:1 compression ratio with standard flywheel diameters.

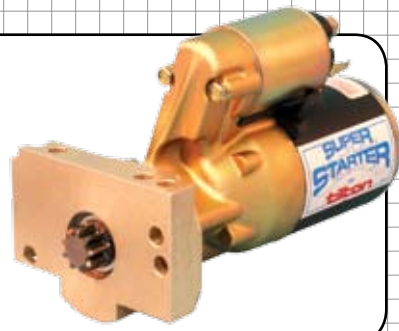

STANDARD DUTY SUPER STARTER PERFORMANCE CHART »

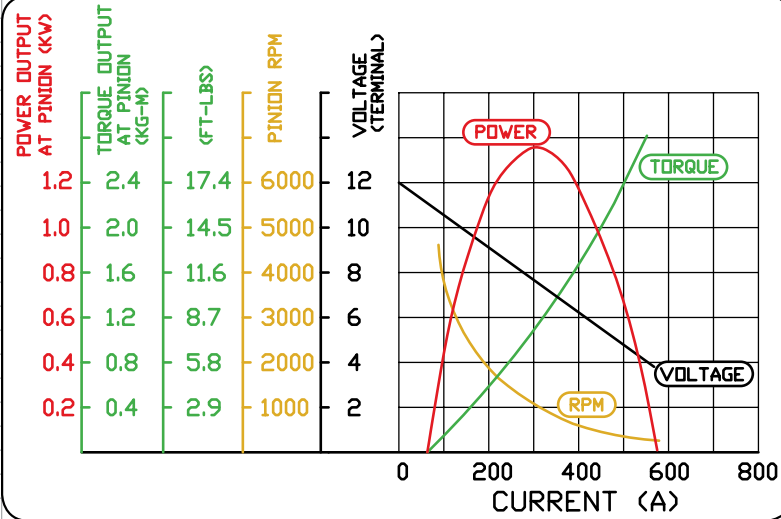

Note:

Super Starter® P/N 54-10001 shown here.
Below dimensions are nominal, please contact Tilton Engineering for detailed dimensions.

MEASUREMENT DIAGRAMS

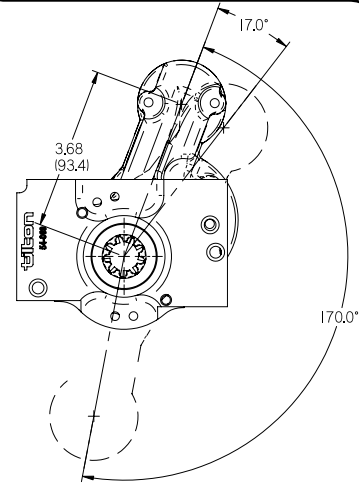
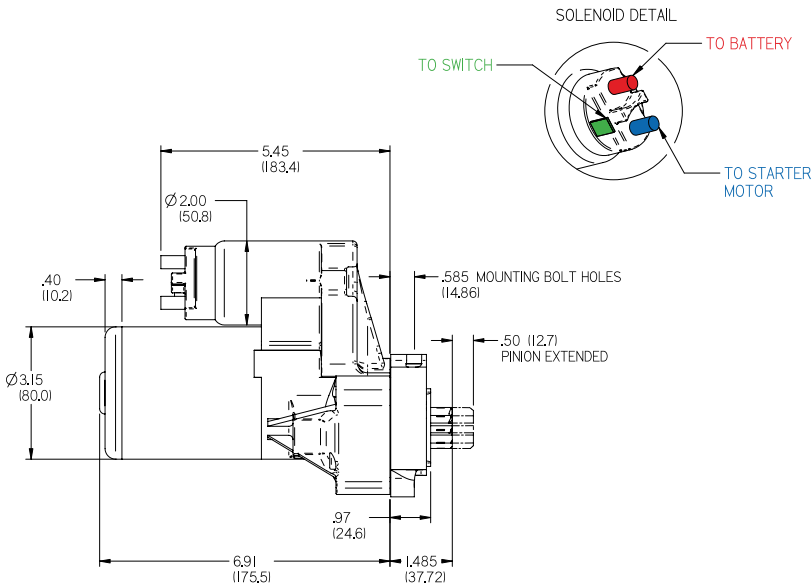

Specifications

- 3.0 hp (2.2 Kw) motor
- Weighs approximately 12 lbs. (varies by application)

Recommended Use

Recommended use on engines larger than 400 C.I.D. and/or over 11:1 compression ratio with standard or small diameter flywheel.

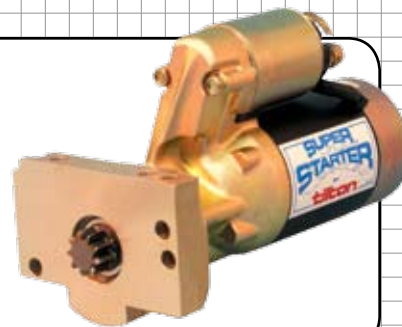

SEVERE DUTY SUPER STARTER PERFORMANCE CHART »

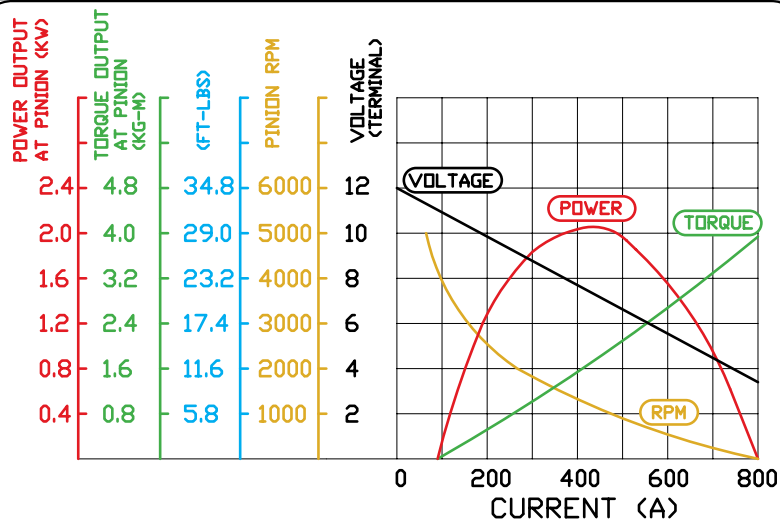

Note:

Super Starter® P/N 54-20001 shown here. Below dimensions are nominal, please contact Tilton Engineering for detailed dimensions.

MEASUREMENT DIAGRAMS

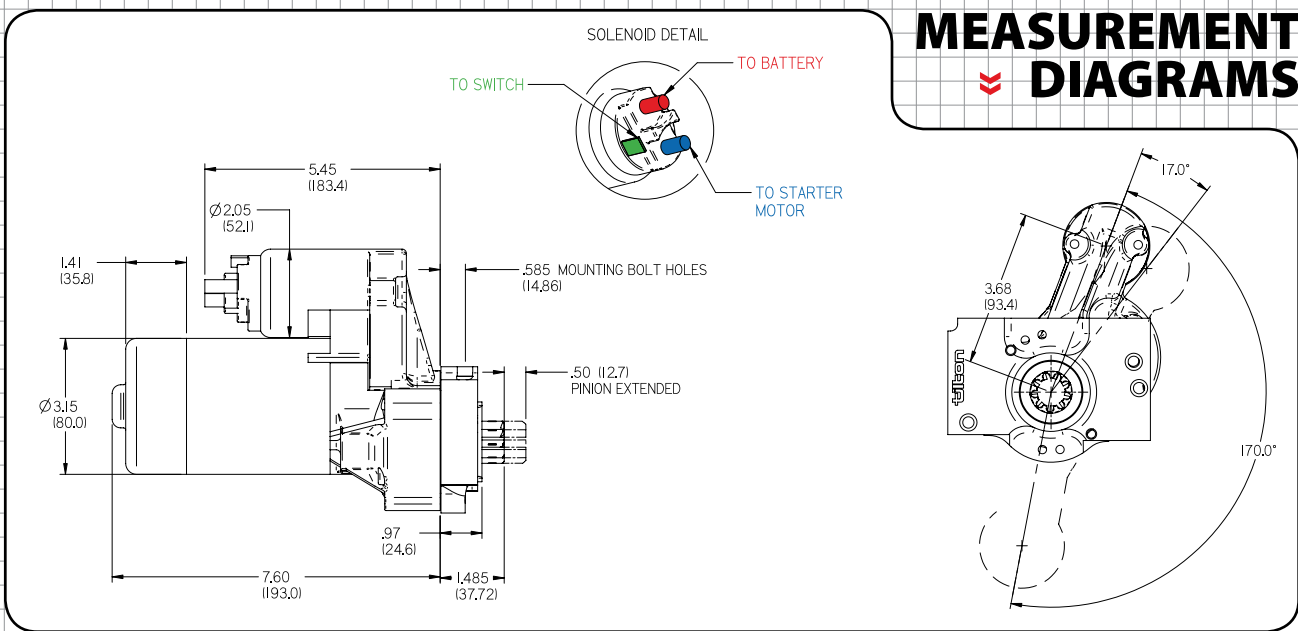

Specifications

- 1.6 hp (1.2 Kw) motor
- Weighs approximately 7 lbs. (varies by application)

Recommended Use

Recommended use on most engines up to 400 C.I.D. and/or less than 10.5:1 compression ratio with standard flywheel diameters.



XLT SUPER STARTER PERFORMANCE CHART »

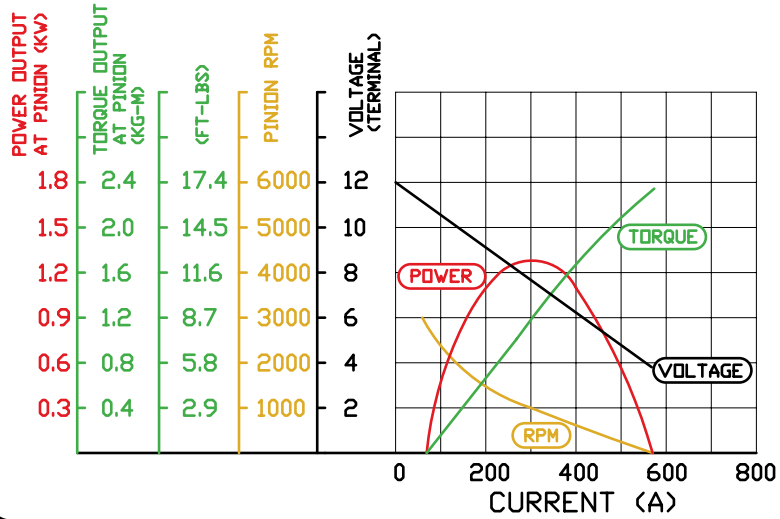

Note:

Super Starter® P/N 54-50001 shown here.
Below dimensions are nominal, please contact Tilton Engineering for detailed dimensions.

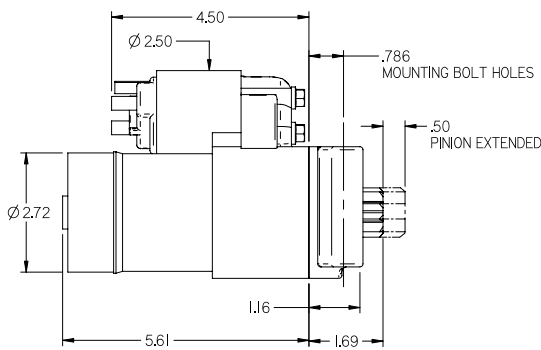
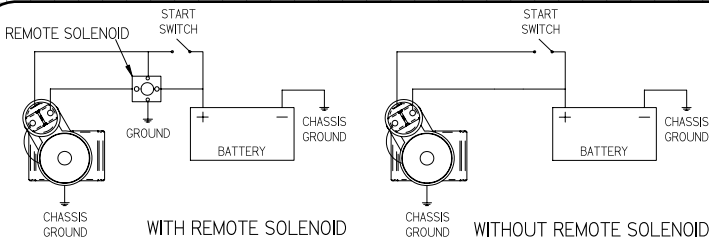

MEASUREMENT DIAGRAMS

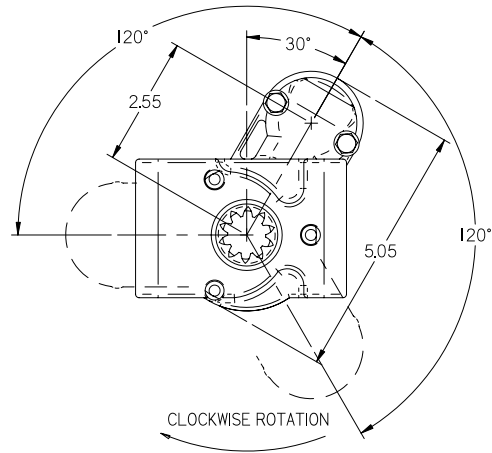

Specifications

- 2.3 hp (1.7 Kw) motor
- Weighs approximately 9 lbs. (varies by application)

Recommended Use

Recommended use on custom specialty applications requiring a high torque starter with compact dimensions.

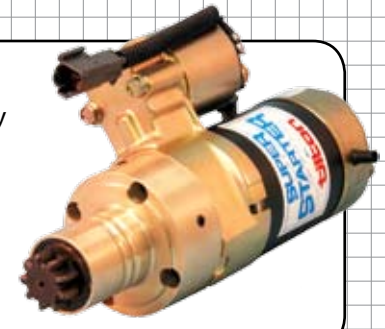

PMT SUPER STARTER PERFORMANCE CHART »

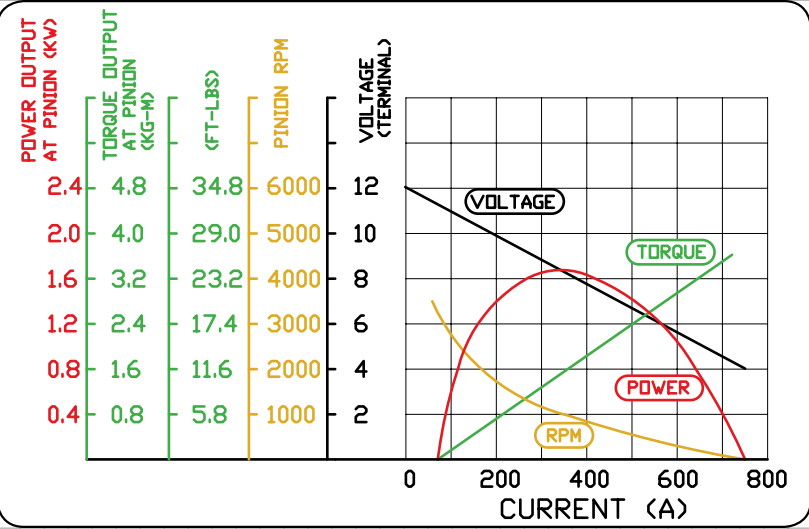

Note:

Super Starter® P/N 54-31070 shown here.
Below dimensions are nominal, please contact Tilton Engineering for detailed dimensions.

MEASUREMENT DIAGRAMS

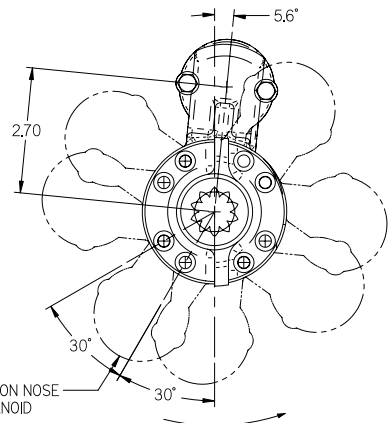
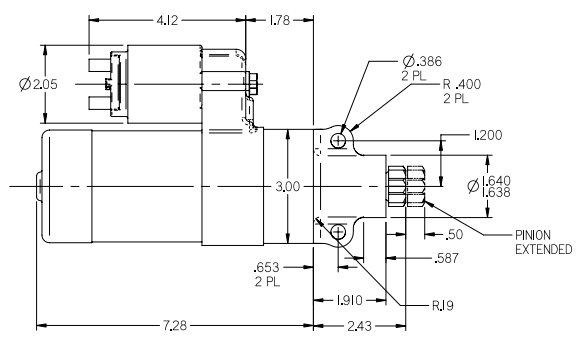
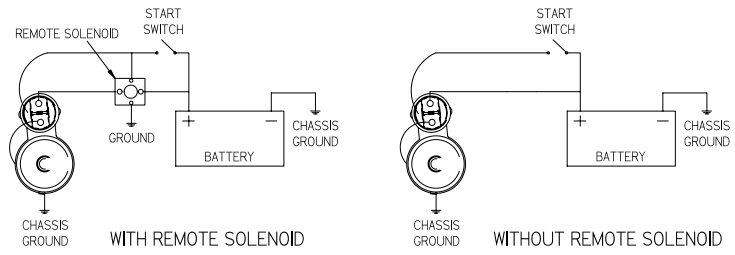

COUNTER-CLOCKWISE ROTATION
REVERSE ROTATION STARTER



Chrome Plated

Chrome plating is available on most Super Starter® models. A chrome model can be designated by placing a "1" in the third part number location.



Example: 54-XX1XX

Chrome plating provides a bright metallic finish that looks great and cleans easily.

Marine Sealed

Marine sealing is available on most Super Starter® models as well. A marine sealed model can be designated by placing a "2" in the third part number location.



Example: 54-XX2XX

Marine sealing your Super Starter®, whether for added protection or for marine use applications, helps prevent moisture from damaging vital electric components. All seams are sealed with a high-grade, RTV silicone sealant.

AMC V8

Fits 290-401 C.I.D.

PART NUMBERS ▼

S 54-10026
Sd 54-20026

Replacement Parts:

Drive Assembly - 54-021
Pinion Kit - 54-042
Solenoid - 54-022A
Mounting Block - 54-086



Also available: **C** **M**

Bert/Brinn/Falcon

Fits Bert, Brinn and Falcon transmissions.

PART NUMBERS ▼

S 54-10040
Sd 54-20040

Replacement Parts:

Drive Assembly - N/A
Pinion Kit - 54-0431
S Solenoid - 54-022
Sd Solenoid - 54SD-022
Mounting Block - 54-067



Buick

Fits 400-455 C.I.D. engines.

PART NUMBERS ▼

S 54-10020
Sd 54-20020

Replacement Parts:

Drive Assembly - 54-021
Pinion Kit - 54-042
S Solenoid - 54-022
Sd Solenoid - 54SD-022
Mounting Block - 54-071



Also available: **C** **M**

Chevy

Fits V8 & 90 degree V6 engines, 153 and 168-tooth ring gears, passenger-side mount.

PART NUMBERS ▼

S 54-10001
Sd 54-20001

Replacement Parts:

Drive Assembly - 54-021
Pinion Kit - 54-042
S Solenoid - 54-022
Sd Solenoid - 54SD-022
Mounting Block - 54-069

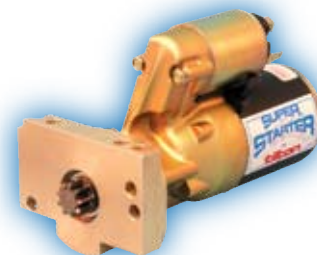

Also available: **C** **M**

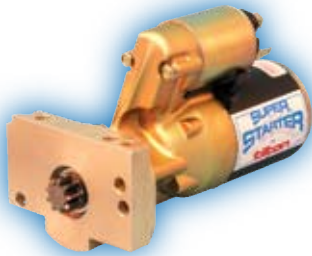

Fits V8 & 90 degree V6 engines, 153 and 168-tooth ring gears, passenger-side mount.

Chevy

Replacement Parts:

- Drive Assembly - 54-021R
- Pinion Kit - 54-042R
- S** Solenoid - 54-022
- Sd** Solenoid - 54SD-022
- Mounting Block- 54-069

- S** 54-11001 (REVERSE ROTATION)
- Sd** 54-21001 (REVERSE ROTATION)

Also available: **C** **M**

▶ PART NUMBERS



Fits V8 & 90 degree V6 engines, 153-tooth ring gear only, passenger-side mount. *Lightweight.*

Chevy

Replacement Parts:

- Drive Assembly - 54-021
- Pinion Kit - 54-042
- Solenoid - 54-022
- Mounting Block- 54-189

- S** 54-10089

▶ PART NUMBERS



Fits V8 & 90 degree V6 engines, 153-tooth ring gear only, passenger-side mount. *Includes CAST aluminum nose.*

Chevy

Replacement Parts:

- Drive Assembly - 54-5400
- Pinion Kit - N/A
- Solenoid - 54-5500
- Mounting Block- 54-169

- X** 54-50001

▶ PART NUMBERS



Fits V8 & 90 degree V6 engines, 153-tooth ring gear only, passenger-side mount. *Includes BILLET aluminum nose.*

Chevy

Replacement Parts:

- Drive Assembly - 54-5400
- Pinion Kit - N/A
- Solenoid - 54SD-022
- Mounting Block- 54-584

- Sd** **X** 54-50684

▶ PART NUMBERS



Fits V8 engines, passenger-side mount

Chevy

Replacement Parts:

- Drive Assembly - 54-020
- Pinion Kit - 54-043
- S** Solenoid - 54-022
- Sd** Solenoid - 54SD-022
- Mounting Block- 54-052
- Adapter Block- 54-024 (104T)
- Adapter Block- 54-025 (105/109T)

- S** 54-10005 104-tooth ring gear
- Sd** 54-20005 104-tooth ring gear
- S** 54-10009 105/109-tooth ring gear
- Sd** 54-20009 105/109-tooth ring gear

▶ PART NUMBERS



Fits early V8 & 6-cyl. engines, bellhousing mount.

Chevy

Replacement Parts:

- Drive Assembly - 54-021
- Pinion Kit - 54-042
- S** Solenoid - 54-022
- Sd** Solenoid - 54SD-022
- Mounting Block- 54-063

- S** 54-10015
- Sd** 54-20015

▶ PART NUMBERS

Chevy

Fits V8 engines, 153 and 168-tooth ring gears, driver-side mount.

PART NUMBERS ▼

S	54-10041
Sd	54-20041

Replacement Parts:

Drive Assembly -	54-021
Pinion Kit -	54-042
S Solenoid -	54-022
Sd Solenoid -	54SD-022
Mounting Block-	54-092



Chevy

Fits V8 engines, 142-tooth, driver-side mount.

PART NUMBERS ▼

Sd	54-20057
-----------	----------

Replacement Parts:

Drive Assembly -	54-021
Pinion Kit -	54-042
Solenoid -	54SD-022
Mounting Block-	54-057



Chrysler

Fits 273-360 C.I.D. engines.

PART NUMBERS ▼

S	54-10000
Sd	54-20000

Also available: **C** **M**

Replacement Parts:

Drive Assembly -	54-020
Pinion Kit -	54-043
S Solenoid -	54-022
Sd Solenoid -	54SD-022
Mounting Block-	54-055



Chrysler

Fits 273-360 C.I.D. engines.

PART NUMBERS ▼

S	54-11000 (REVERSE ROTATION)
----------	-----------------------------

Also available: **C** **M**

Replacement Parts:

Drive Assembly -	54-020R
Pinion Kit -	54-043R
Solenoid -	54-022
Mounting Block-	54-055



Cosworth

Fits Cosworth with Hewland FT200 transmission.

PART NUMBERS ▼

X	54-50086
----------	----------

Replacement Parts:

Drive Assembly -	54-5401
Pinion Kit -	N/A
Solenoid -	54-5500
Mounting Block-	54-586

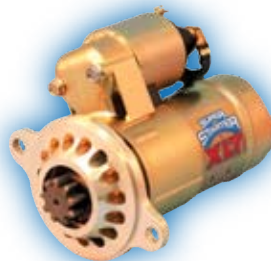

Cosworth

Fits Cosworth with Hewland FT200 transmission.

PART NUMBERS ▼

S	54-10086
----------	----------

Replacement Parts:

Drive Assembly -	54-020
Pinion Kit -	54-043
Solenoid -	54-022
Mounting Block-	54-090





Fits 289/302/351W, 390/427/428 & 2.0/2.3L engines with automatic, 4-spd. & 5-spd transmissions (.725" offset) - *Offset is distance from starter mount surface to engine-side of the ring gear.*

Ford

Replacement Parts:

- Drive Assembly - 54-021
- Pinion Kit - 54-042
- S** Solenoid - 54-022A
- Sd** Solenoid - 54SD-022
- Mounting Block- 54-060

S	54-10013
Sd	54-20013

Also available: **C** **M**

▶ PART NUMBERS



Fits 289/302/351W, 390/427/428 & 2.0/2.3L engines with automatic, 4-spd. & 5-spd transmissions (.725" offset) - *Offset is distance from starter mount surface to engine-side of the ring gear.*

Ford

Replacement Parts:

- Drive Assembly - 54-021
- Pinion Kit - 54-042
- S** Solenoid - 54-022A
- Sd** Solenoid - 54SD-022
- Mounting Block- 54-060

S	54-10913 (Chevy type solenoid)
Sd	54-20913 (Chevy type solenoid)

Also available: **C** **M**

▶ PART NUMBERS



Fits Pre-1967 289/302/351W engines with 3-spd. & 4-spd transmissions (.350" offset).
Offset is distance from starter mount surface to engine-side of the ring gear.

Ford

Replacement Parts:

- Drive Assembly - 54-021
- Pinion Kit - 54-042
- Solenoid - 54-022A
- Mounting Block- 54-064

S	54-10018
Sd	54-20018

Also available: **C** **M**

▶ PART NUMBERS



Fits 351M & 400/429/460 engines (.600" offset).
Offset is distance from starter mount surface to engine-side of the ring gear.

Ford

Replacement Parts:

- Drive Assembly - 54-021
- Pinion Kit - 54-042
- S** Solenoid - 54-022A
- Sd** Mounting Block- 54-061

S	54-10014
Sd	54-20014

Also available: **C** **M**

▶ PART NUMBERS



4.6/5.4/6.8L modular V8 engines

Ford

Replacement Parts:

- Drive Assembly - 54-5400
- Pinion Kit - N/A
- Solenoid - 54-5500
- Solenoid - 54SD-022
- Mounting Block- 54-587

X	54-50087
----------	----------

▶ PART NUMBERS



Fits Formula Ford cars with 110-tooth ring gear and Hewland MK5/MK8 transmission.

Formula Ford

Replacement Parts:

- Drive Assembly - 54-020
- Pinion Kit - 54-043
- Solenoid - 54-022
- Mounting Block- 54-130

S	54-10030
----------	----------

▶ PART NUMBERS

Formula Ford

Fits Formula Ford cars with 110-tooth ring gear and Hewland MK5/MK8 transmission.

PART NUMBERS ▼

X 54-50030

Replacement Parts:

Drive Assembly - 54-5401
 Pinion Kit - N/A
 Solenoid - 54-5500
 Mounting Block - 54-530



Also available: **C** **M**

Jaguar

Fits V12 engine.

PART NUMBERS ▼

S 54-10027

Replacement Parts:

Drive Assembly - 54-021
 Pinion Kit - 54-042
 Solenoid - 54-022
 Mounting Block - 54-088



Jaguar

Fits 4.2L V6 engine.

PART NUMBERS ▼

S 54-10029

Replacement Parts:

Drive Assembly - 54-021
 Pinion Kit - 54-042
 Solenoid - 54-022
 Mounting Block - 54-089



Mercury

Fits Mercury Marine adapters. *Starters are "Marine Sealed."*

PART NUMBERS ▼

M S 54-10254
M Sd 54-20254

Replacement Parts:

Drive Assembly - 54-021L
 Pinion Kit - 54-042L
S Solenoid - 54-022
Sd Solenoid - 54SD-022
 Mounting Block - 54-078



Mercury

Fits Mercury Marine adapters. Replacement for Delco P/N 1108525. *Starters are "Marine Sealed."*

PART NUMBERS ▼

M S 54-11254 (REVERSE ROTATION)
M Sd 54-21254 (REVERSE ROTATION)

Replacement Parts:

Drive Assembly - 54-021RL
 Pinion Kit - 54-042RL
S Solenoid - 54-022
Sd Solenoid - 54SD-022
 Mounting Block - 54-078



MG/Austin Healey/Triumph

Fits MG Midget, Austin Healey Sprite and Triumph Spitfire.

PART NUMBERS ▼

S 54-10074

Replacement Parts:

Drive Assembly - 54-020
 Pinion Kit - 54-043
 Solenoid - 54-022
 Mounting Block - 54-098



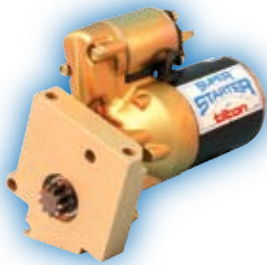

Fits 350-455 C.I.D. engine.

Oldsmobile

Replacement Parts:

- Drive Assembly - 54-021
- Pinion Kit - 54-042
- S** Solenoid - 54-022
- Sd** Solenoid - 54SD-022
- Mounting Block- 54-072

S	54-10031
Sd	54-20031

Also available: **C** **M**

▶ PART NUMBERS



Fits aluminum 215 V8 engine.

Oldsmobile

Replacement Parts:

- Drive Assembly - 54-021
- Pinion Kit - 54-042
- Solenoid - 54-022
- Mounting Block- 54-075

S	54-10022
----------	----------

Also available: **C** **M**

▶ PART NUMBERS

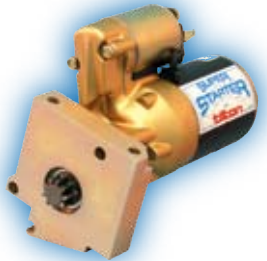

Fits 1965-on 350-455 C.I.D. engines.

Pontiac

Replacement Parts:

- Drive Assembly - 54-021
- Pinion Kit - 54-042
- S** Solenoid - 54-022
- Sd** Solenoid - 54SD-022
- Mounting Block- 54-084

S	54-10021
Sd	54-20021

Also available: **C** **M**

▶ PART NUMBERS

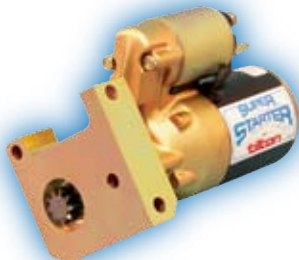

Fits 4-cyl. "Iron Duke" engine with 142-tooth ring gear.

Pontiac

Replacement Parts:

- Drive Assembly - 54-021
- Pinion Kit - 54-042
- Solenoid - 54-022
- Mounting Block- 54-058

S	54-10011
----------	----------

Also available: **C** **M**

▶ PART NUMBERS



Fits pre-1989 911/914/930 models.

Porsche

Replacement Parts:

- Drive Assembly - 54-021R
- Pinion Kit - 54-042R
- S** Solenoid - 54-022
- Sd** Solenoid - 54SD-022
- Mounting Block- 54-076

S	54-11061
Sd	54-21061

Also available: **C** **M**

▶ PART NUMBERS



Fits 928 model.

Porsche

Replacement Parts:

- Drive Assembly - 54-021
- Pinion Kit - 54-042
- Solenoid - 54-022
- Mounting Block- 54-076

S	54-10037
----------	----------

Also available: **C** **M**

▶ PART NUMBERS

Quarter Master

Fits Quarter Master starter bellhousings.

PART NUMBERS ▼

S	54-11052
Sd	54-21052

Replacement Parts:

Drive Assembly -	54-021R
Pinion Kit -	54-042R
S Solenoid -	54-022
Sd Solenoid -	54SD-022
Mounting Block-	54-073



Sonic Racing Products

Fits Sonic Racing Products rear-mounted starter bellhousings with 105-tooth ring gear.

PART NUMBERS ▼

S	54-11052
Sd	54-21052

Replacement Parts:

Drive Assembly -	54-021R
Pinion Kit -	54-042R
S Solenoid -	54-022
Sd Solenoid -	54SD-022
Mounting Block-	54-073



Superflow

Fits Superflow Dyno.

PART NUMBERS ▼

Sd	54-21055
-----------	----------

Replacement Parts:

Drive Assembly -	54-021R
Pinion Kit -	54-042R
Solenoid -	54SD-022
Mounting Block-	54-078



Swift

Fits Swift 008.a & 014.a chassis.

PART NUMBERS ▼

P	54-31470
----------	----------

Replacement Parts:

Drive Assembly -	59-020
Pinion Kit -	N/A
Solenoid -	54-022R
Mounting Block-	54-050



Swift

Fits Swift 016.a chassis.

PART NUMBERS ▼

P	54-31587
----------	----------

Replacement Parts:

Drive Assembly -	59-020
Pinion Kit -	N/A
Solenoid -	54-022
Mounting Block-	54-053



Tilton Bellhousing

Fits Tilton UTGC rear-mount starter bellhousings with 102-tooth ring gear.

PART NUMBERS ▼

Sd	54-21062
-----------	----------

Replacement Parts:

Drive Assembly -	54SD-021R-13
Pinion Kit -	54SD-042R-13
Solenoid -	54SD-022
Mounting Block-	54-073





Fits Tilton 53-series OE Mono (1 piece) bellhousings, Dodge R5/R7.

Tilton Bellhousing

Replacement Parts:

- Drive Assembly - 54-5400
- Pinion Kit - N/A
- Solenoid - 54SD-022
- Mounting Block- 54-594

Sd X

54-50694

PART NUMBERS



Fits Tilton 53-series OE Mono (1-piece) bellhousings, Ford

Tilton Bellhousing

Replacement Parts:

- Drive Assembly - 54-021
- Pinion Kit - 54-042
- Solenoid - 54-022
- Mounting Block- 54-183

S

54-10083

PART NUMBERS



Fits Tilton 53-series OE Mono (1-piece) bellhousings, Ford.

Tilton Bellhousing

Replacement Parts:

- Drive Assembly - 54-5400
- Pinion Kit - N/A
- Solenoid - 54SD-022
- Mounting Block- 54-583

Sd X

54-50083

PART NUMBERS



Fits Tilton 53-series OE Modular (2-piece) bellhousings/mount plate, Ford.

Tilton Bellhousing

Replacement Parts:

- Drive Assembly - 54-021
- Pinion Kit - 54-042
- Solenoid - 54-022
- Mounting Block- 54-054

S

54-10010

PART NUMBERS



Fits Tilton 53-series OE Modular (2-piece) bellhousings/mount plate, Ford.

Tilton Bellhousing

Replacement Parts:

- Drive Assembly - 54-5400
- Pinion Kit - N/A
- Solenoid - 54-5500
- Mounting Block- 54-154

X

54-50010

PART NUMBERS



Fits Tilton early-style 59-series bellhousing, pinch style mount, 9-tooth pinion gear.

Tilton Bellhousing

Replacement Parts:

- Drive Assembly - 59-020
- Pinion Kit - N/A
- Solenoid - 54-022R
- Mounting Block- 54-050

P

54-31070

PART NUMBERS

Tilton Bellhousing

Fits Tilton late-style 59-series bellhousing, 2 bolt mount, 10-tooth pinion gear.

PART NUMBERS ▼

P 54-31087

Replacement Parts:

- Drive Assembly - 59-019
- Pinion Kit - N/A
- Solenoid - 54-022R
- Mounting Block- 54-053



Tilton Bellhousing

Fits Dodge Viper GTS-R bellhousing.

PART NUMBERS ▼

P 54-31071

Replacement Parts:

- Drive Assembly - 59-019
- Pinion Kit - N/A
- Solenoid - 54-022R
- Mounting Block- 54-051



Volkswagen

Fits VW (air cooled) transaxles and other VW type transaxles, such as: Fortin, Mendeola, Weddle, etc.

PART NUMBERS ▼

S 54-11053
Sd 54-21053

Replacement Parts:

- Drive Assembly - 54-021R
- Pinion Kit - 54-042R
- S** Solenoid - 54-022
- Sd** Solenoid - 54SD-022
- Mounting Block- 54-076



Universal

For use in custom applications. Includes 9-tooth, 12 pitch pinion gear.

PART NUMBERS ▼

S 54-10010

Replacement Parts:

- Drive Assembly - 54-021
- Pinion Kit - 54-042
- Solenoid - 54-022
- Mounting Block- 54-054



Universal

For use in custom applications. Includes 9-tooth, 12 pitch pinion gear.

PART NUMBERS ▼

S 54-11010 (REVERSE ROTATION)

Replacement Parts:

- Drive Assembly - 54-021R
- Pinion Kit - 54-042R
- Solenoid - 54-022
- Mounting Block- 54-054



Universal

For use in custom applications. Includes 9-tooth, 10 pitch pinion gear.

PART NUMBERS ▼

S 54-10007

Replacement Parts:

- Drive Assembly - 54-020
- Pinion Kit - 54-043
- Solenoid - 54-022
- Mounting Block- 54-054





For use in custom applications. Includes 9-tooth, 10 pitch pinion gear.

Universal

Replacement Parts:

- Drive Assembly - 54-020R
- Pinion Kit - 54-043R
- S** Solenoid - 54-022
- Sd** Mounting Block- 54-054

S 54-11007 (REVERSE ROTATION)

▶ PART NUMBERS

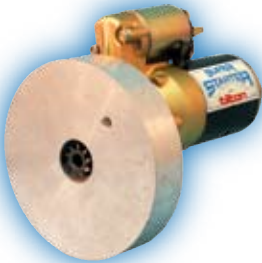

For use in custom applications. Mounting nose to be machined by customer. Includes 9-tooth, 12 pitch pinion gear.

Universal

Replacement Parts:

- Drive Assembly - 54-021
- Pinion Kit - 54-042
- S** Solenoid - 54-022
- Sd** Solenoid - 54SD-022
- Mounting Block- 54-10

S 54-10092

Sd 54-20092

▶ PART NUMBERS



For use in custom applications. Mounting nose to be machined by customer. Includes 9-tooth, 12 pitch pinion gear.

Universal

Replacement Parts:

- Drive Assembly - 54-021R
- Pinion Kit - 54-042R
- S** Solenoid - 54-022
- Sd** Solenoid - 54SD-022
- Mounting Block- 54-10

S 54-11092 (REVERSE ROTATION)

Sd 54-21092 (REVERSE ROTATION)

▶ PART NUMBERS



For use in custom applications. Mounting nose to be machined by customer. Includes 9-tooth, 10 pitch pinion gear.

Universal

Replacement Parts:

- Drive Assembly - 54-020
- Pinion Kit - 54-043
- S** Solenoid - 54-022
- Sd** Solenoid - 54SD-022
- Mounting Block- 54-10

S 54-10091

Sd 54-20091

▶ PART NUMBERS



For use in custom applications. Includes 9-tooth, 10 pitch pinion gear.

Universal

Replacement Parts:

- Drive Assembly - 54-020R
- Pinion Kit - 54-043R
- S** Solenoid - 54-022
- Sd** Solenoid - 54SD-022
- Mounting Block- 54-10

S 54-11091 (REVERSE ROTATION)

Sd 54-21091 (REVERSE ROTATION)

▶ PART NUMBERS



Super Starter® sub-assembly. Does not include drive assembly or mounting nose.

Universal

Replacement Parts:

- Drive Assembly - N/A
- Pinion Kit - N/A
- S** Solenoid - 54-022
- Sd** Solenoid - 54SD-022
- Mounting Block- N/A

S 54-099

Sd 54-099R (REVERSE ROTATION)

S 54SD-099

Sd 54SD-099R (REVERSE ROTATION)

▶ PART NUMBERS



Drive Assembly

Using the finest parts available, our drive assemblies are 100% Tilton quality. This kit includes a new pinion gear, sprag assembly, bearings, return spring, cap and clip.



Pinion Kit

Tilton Super Starter forged pinions are made to last. The kit includes new pinion gear, return spring, cap and clip.



Solenoid

These durable solenoid kits include a new solenoid, spring and gasket.



Mounting Block

Machined from billet aluminum, each unique mounting nose is crafted to exacting standards.

Authorized Super Starter® Repair Centers

(Please contact your nearest repair center)

- **Tilton Engineering - West Coast**

805.688.2353
www.tiltonracing.com

- **Phil's Starters - East Coast**

704.435.2934



SUPER STARTER®

The ORIGINAL and STILL the BEST

The Tilton Super Starter® is the original high torque mini-starter and the benchmark for performance and reliability. Since its introduction in 1981, the Super Starter® has earned a reputation for uncompromising quality. This reputation has made the Super Starter® the most widely used starter in motorsports... Including 12 & 24-hour endurance racing, NASCAR, NHRA, off-road, road and short-track racing.

Super Starters are continually improved using the experience gained with our involvement in motorsports and the input we receive from customers. Often imitated, but never duplicated, the Super Starter® is the ultimate in starter technology.

From hot rods to prototype race cars and everything in-between, the Super Starter® is your best choice!

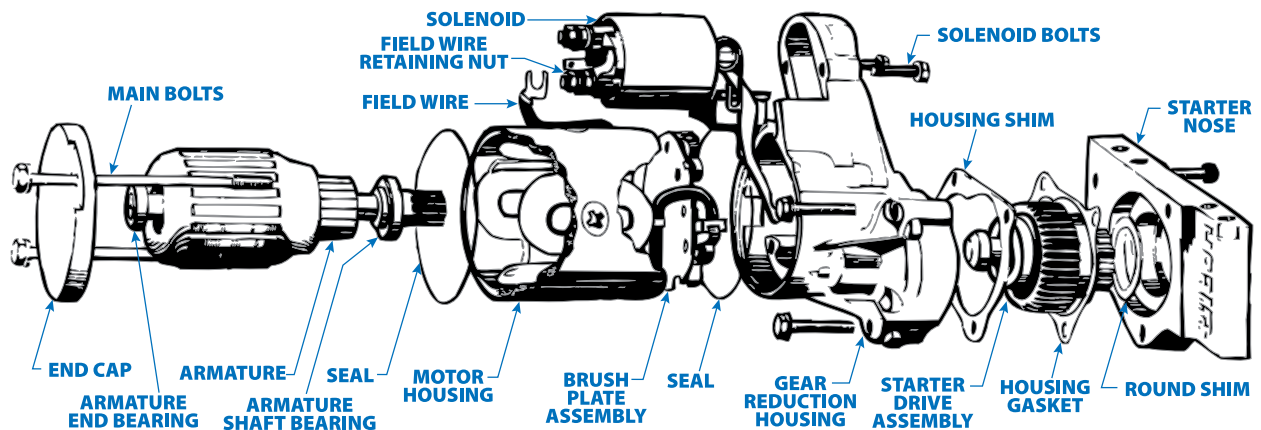

Super Starter® Features & Benefits:

- Assembled With New, High Quality Components
- Gear Reduction
- Multiple Solenoid Clocking Positions (Most Models)
- Full Ball Bearing (Or Needle Bearing) Design
- Epoxy Encapsulated Armature
- Lightweight
- Compact Size
- High Level Of Performance and Reliability
- High Cranking Torque
- Installation Flexibility and Added Clearance
- Reduced Drag
- Vibration, Heat and Moisture Resistance
- Weight Saving
- Increased Header, Oil Pan and Frame Clearance

\$3.00 (P/N 98-258-1)

Distributed By:



tilton
DRIVELINE COMPONENTS

SONIC
RACING PRODUCTS

tb&c
TILTON BRAKE
& CONTROLS

**SUPER
STARTER**

tilton
Performance

Tilton Engineering

25 Easy Street • PO Box 1787 • Buellton, CA 93427

www.tiltonracing.com