



FIXED MOUNT ROTOR MOUNTING HATS

www.wilwood.com

ROTOR MOUNTING HATS

HD SERIES FIXED MOUNT ROTOR HATS:

Wilwood's HD Series Fixed Mount Rotor Hats have a long standing reputation for fit, performance, and durability. HD Series hats are manufactured from premium grade aluminum alloys offering high strength, low weight, and show quality appeal. HD hats have not only been a mainstay in many of Wilwood's racing disc brake conversion kits, but they can cover a range of applications from an OE four lug axle shaft to a Grand-National stock car racing hub. HD hats feature a straight bell construction with a flanged rotor mount ring. These features combine to provide maximum radial clearance between the caliper body and the hat. This can be a critical factor when trying to squeeze a large caliper inside a small wheel. Many hats offer multi-lug wheel patterns for added versatility. Some hats can be ordered blank for custom axle building and other unique applications.

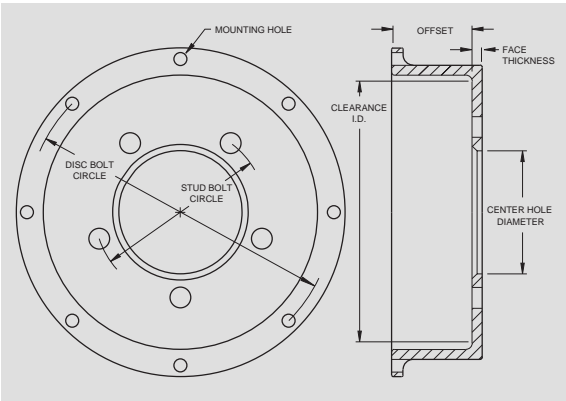

The HD hat configurations are divided into two groups. There are threaded hole hats for use with through-hole mount rotors, and there are through-hole mount hats for use with threaded hole rotors. When used with matching Wilwood rotor hardware, these hats provide solid mounting for a wide range of custom and competition disc brake applications. Use the charts below to match the rotor mount, lug pattern, offset, and the other dimensions necessary for each application.



HD FIXED MOUNT ALUMINUM HATS FOR 5/16-24 THREADED HOLE ROTORS ORDERING INFORMATION:

ROTOR BOLT CIRCLE	WHEEL LUG PATTERN	HAT OFFSET	STUD HOLE DIAMETER	CENTER HOLE I.D.	FACE THICKNESS	CLEARANCE I.D.	MOUNT HOLE	HAT PART NUMBER	ROTOR BOLT KIT NUMBER	NOTES
8 x 7.62"	6 x 5.00"	2.00"	.64"	3.50"	.25"	6.50"	.323"	170-0089	230-0150	
8 x 7.62"	5 x 4.50/4.75/5.00"	2.00"	.52"	3.06"	.25"	6.50"	.323"	170-1827	230-0150	(2)
8 x 7.62"	5 x 4.75"	1.50"	.51"	2.85"	.50"	6.51"	.323"	170-0176	230-0150	
8 x 7.62"	5 x 4.50"	2.10"	.50"	2.75"	.25"	6.31"	.323"	170-0636	230-0150	
8 x 7.62"	5 x 4.50"	1.38"	.67"	3.23"	.25"	6.27"	.323"	170-0635	230-0150	
8 x 7.62"	5 x 4.50"	1.25"	.52"	3.06"	.25"	6.32"	.323"	170-3265	230-0150	
8 x 7.62"	4 x 4.25"	2.00"	.52"	3.06"	.29"	6.50"	.323"	170-2637	230-0150	
8 x 7.62"	4 x 4.25"	1.25"	.52"	3.06"	.29"	6.32"	.323"	170-3149	230-0150	
8 x 7.62"	Undrilled	2.00"	—	2.78"	.25"	6.50"	.323"	171-2233	230-0150	

HD FIXED MOUNT ALUMINUM HATS FOR 5/16' THROUGH-HOLE ROTORS ORDERING INFORMATION:

ROTOR BOLT CIRCLE	WHEEL LUG PATTERN	HAT OFFSET	STUD HOLE DIAMETER	CENTER HOLE I.D.	FACE THICKNESS	CLEARANCE I.D.	MOUNT HOLE	HAT PART NUMBER	ROTOR BOLT KIT NUMBER	NOTES
8 x 7.00"	5 x 4.75/5.00"	1.96"	.70"	3.06"	.25"	6.14"	5/16-18	170-5244	230-0233D	(1)
8 x 7.00"	5 x 4.50/4.75/5.00"	1.96"	.52"	3.06"	.25"	6.14"	5/16-18	170-0208	230-0233D	(1)
8 x 7.00"	5 x 4.50/4.75/5.00"	1.77"	.52"	3.06"	.25"	6.14"	5/16-18	170-0357	230-0233D	(1)
8 x 7.00"	5 x 4.50/4.75/5.00"	1.71"	.52"	3.06"	.25"	6.14"	5/16-18	170-0259	230-0233D	(1)
8 x 7.00"	5 x 4.50/4.75/5.00"	1.59"	.52"	3.06"	.25"	6.14"	5/16-18	170-0317	230-0233D	(1)
8 x 7.00"	5 x 4.50/4.75/5.00"	1.41"	.52"	3.06"	.50"	6.14"	5/16-18	170-0764	230-0233D	(1)
8 x 7.00"	4 X 4.50"	1.41"	.51"	2.68"	.50"	6.14"	5/16-18	170-1754	230-0233D	(1)
8 x 7.00"	Undrilled	1.96"	—	3.06"	.25"	6.14"	5/16-18	171-3753	230-0233D	(1)
8 x 7.00"	Undrilled	1.71"	—	3.06"	.25"	6.14"	5/16-18	171-3754	230-0233D	(1)
8 x 7.00"	Undrilled	1.59"	—	3.06"	.25"	6.14"	5/16-18	171-3755	230-0233D	(1)
8 x 7.00"	Undrilled	1.41"	—	2.78"	.50"	6.14"	5/16-18	171-2234	230-0233D	(1)

NOTES:

- (1) ROTOR BOLT KIT P/N 230-0233D INCLUDES A SHORT PROFILE HEX HEAD BOLT THAT PROVIDES ADDITIONAL CLEARANCE BETWEEN THE BOLT HEAD & THE CALIPER MOUNTING HARDWARE AS USED IN WILWOOD LIGHTWEIGHT READ DRAG KITS. THESE HATS CAN ALSO BE USED WITH BOLT KIT P/N 230-2589, OTHER APPLICATIONS WHERE ADDITIONAL CLEARANCE EXISTS BETWEEN THE ROTOR BOLT HEAD & THE CALIPER MOUNT HARDWARE
- (2) THIS HAT IS UN-ANODIZED

WARNING: The user or installer of any product from this catalog must determine its suitability for their intended purpose or application