

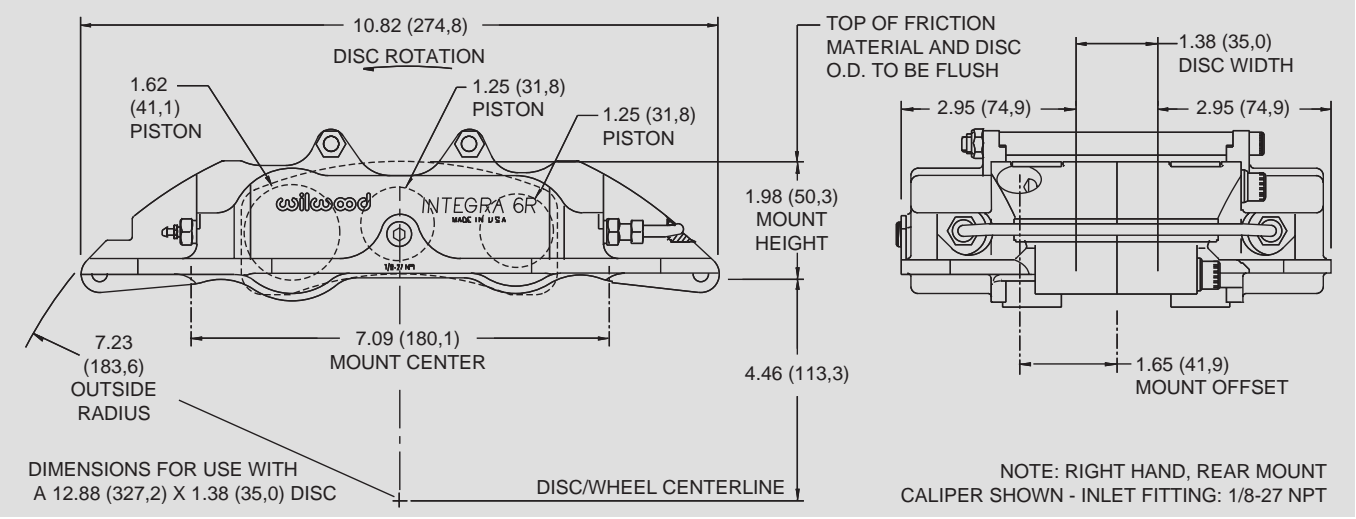

**INTEGRA 6R RADIAL MOUNT CALIPER, MOUNTING DIMENSIONS:**

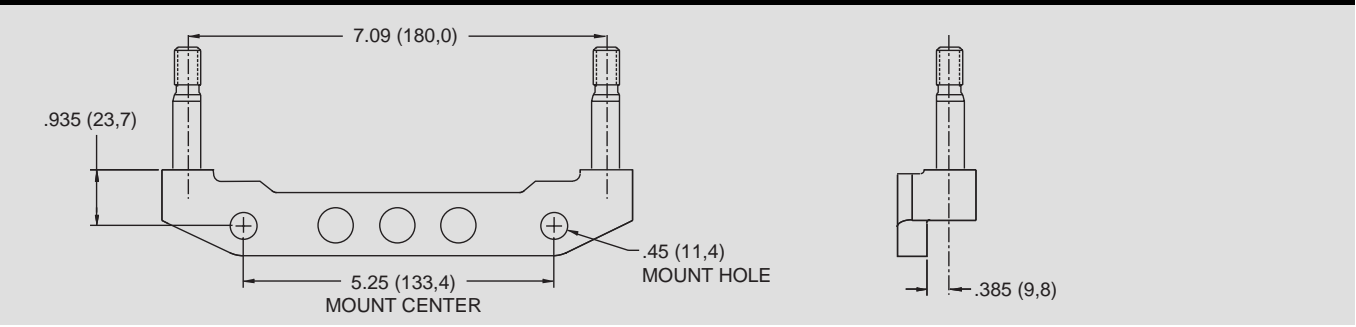

**RADIAL CALIPER TO LUG MOUNT ADAPTER BRACKET, P/N 250-5687 - ALUMINUM, OR 250-7423 - STEEL:**



**INTEGRA 6R BRAKE PAD TYPE 9625 - VOLUME = 7.2 CU. IN. / 9725 - VOLUME = 8.0 CU. IN. / 9828 - VOLUME = 10.4 CU. IN.:**

HP CONFIGURATION	
AXLE SET P/N	PAD TYPE / COMPOUND
15A - 5741K	9828 A PolyMatrix
15H - 8110K	9828 H PolyMatrix

IP CONFIGURATION	
AXLE SET P/N	PAD TYPE / COMPOUND
15A - 5740K	9725 A PolyMatrix
15H - 8109K	9725 H PolyMatrix

LP CONFIGURATION	
AXLE SET P/N	PAD TYPE / COMPOUND
15A - 5765K	9625 A PolyMatrix

**SERVICE PARTS ORDERING INFORMATION:**

CALIPER PART NO.	THERMLOCK PISTON	SQ RING KIT (6 PK)	BLEED SCREW KIT (4 PK)	CROSSOVER TUBE KIT (2 PK)	SELF-BLEED TUBE (EA)	BRIDGE BOLT KIT	BRIDGE WEAR PLATE (EA)	MOUNT BOLT AND SHIM KIT
120-5690	200-7402 (1.25") 200-7398 (1.62")	130-5660	220-0627	190-5310	190-5144	230-5004	300-5710 (R/H) 300-5711 (L/H)	230-7031
120-5691	200-7402 (1.25") 200-7398 (1.62")	130-5660	220-0627	190-5310	190-5144	230-5004	300-5710 (R/H) 300-5711 (L/H)	230-7031